

SLC CAPITAL CAMPAIGN

SMALL
STEPS

MIGHTY
STRIDES

Benefiting Special Learning Center





Above: Konlee practices walking with parallel bars in the sensorimotor room.

WALK through our HISTORY

Special Learning Center (SLC) was built on the dreams and possibilities of children with special needs. In the mid-1950s, two schools were formed in Jefferson City to serve children with disabilities. The Goshorn Handicap Center was established by Betty (Goshorn) Weldon and the Andrae family. The Peter Pan School was established by Dr. & Mrs. Everett Sugarbaker, St. Mary's Hospital as well as other supportive families. Both schools offered special education and therapy services to children with disabilities.

In 1985, the two schools merged to form Special Learning Center. In its first year, SLC served 25 children from a location on East High Street. After a capital campaign in 1990, the organization was able to construct

a new facility on Fairgrounds Road. Special Learning Center quickly outgrew this 6,500 square foot building.

In 2001, SLC expanded its facility by adding 7,200 square feet of additional space. The added rooms allowed for a new childcare program as well as expanded therapy services. Special Learning Center began a family support program, Capable Kids and Families®, in 2011 to provide additional services for families. In 2022, SLC formally opened its pediatric outpatient and intensive therapy

clinic, SKIP Clinic (Super Kids, Infinite Possibilities) which provides medical-based physical, occupational and speech therapy services.

Today, Special Learning Center has grown to serve more than 900 children annually from 11 Central Missouri counties and 23 area school districts. During the past 38 years, the organization has helped open doors of opportunity for thousands of children and their families.

✚ Timeline



1950s
Goshorn and Peter Pan Schools created to serve children with special needs



1991
SLC constructs facility on Fairgrounds Road



2011
Capable Kids and Families Program launches providing family support



1985
Debbie Hamler, who served as executive director for 35 years, establishes SLC



2001
The facility expands creating a childcare center and additional therapy services



2022
SKIP Clinic opens to provide medical-based therapy services



MARCH with a MISSION

Our Programs:

Early Childhood Special Education & First Steps Classrooms

This special education preschool program prepares children for their next education placement by providing half day, special instruction classes and education-based therapy services.

Occupational, Physical and Speech Therapy

Educational therapy services are offered to children between the ages of birth and 21 at SLC, in surrounding schools and in homes.

SKIP Clinic

SKIP Clinic provides medical-based, pediatric outpatient and intensive therapy through physical, occupational and speech services in a clinical setting.

Crayon Kids Childcare Program

All-day childcare is provided to children with developmental delays or disabilities as well as to typically developing children who are related to a member of the SLC family.

Family Support Program

Special Learning Center provides family support through its Capable Kids and Families® program which provides home visits, equipment lending, outreach activities and respite for participating families.

Camp Jade

Each summer, Special Learning Center hosts “Camp Jade”, a fun and educational two-week summer camp for school age children with special needs. Camp Jade is named after former SLC student, Jade Renkemeyer.



AJ enjoys learning and socializing while attending the Crayon Kids childcare program.



Teacher, Sarah Neuenswander, educates children in her early childhood special education classroom.

Special Learning Center served a record 929 children from 11 central Missouri counties last year.

As the need for services continues to grow, a larger facility will allow Special Learning Center to reach more children.

By the Numbers

160+ children served in Early Childhood Special Education classrooms.

550+ children offered therapy services.

42 children served in Crayon Kids childcare program.

23 school districts received SLC therapy and special education services.

1,253 therapy appointments completed by SKIP Clinic.

375 home visits & **18** family events hosted by family support specialists.



STRIDE towards the FUTURE

Currently, Special Learning Center is out of space and several programs have a waiting list. A larger facility will allow the Special Learning Center to:

Expand Early Childhood Special Education (ECSE) Classrooms.

The new facility will allow the ECSE program to serve more children by expanding from 6 classrooms to 10 classrooms. Additional classrooms allow for more children to participate in the program.

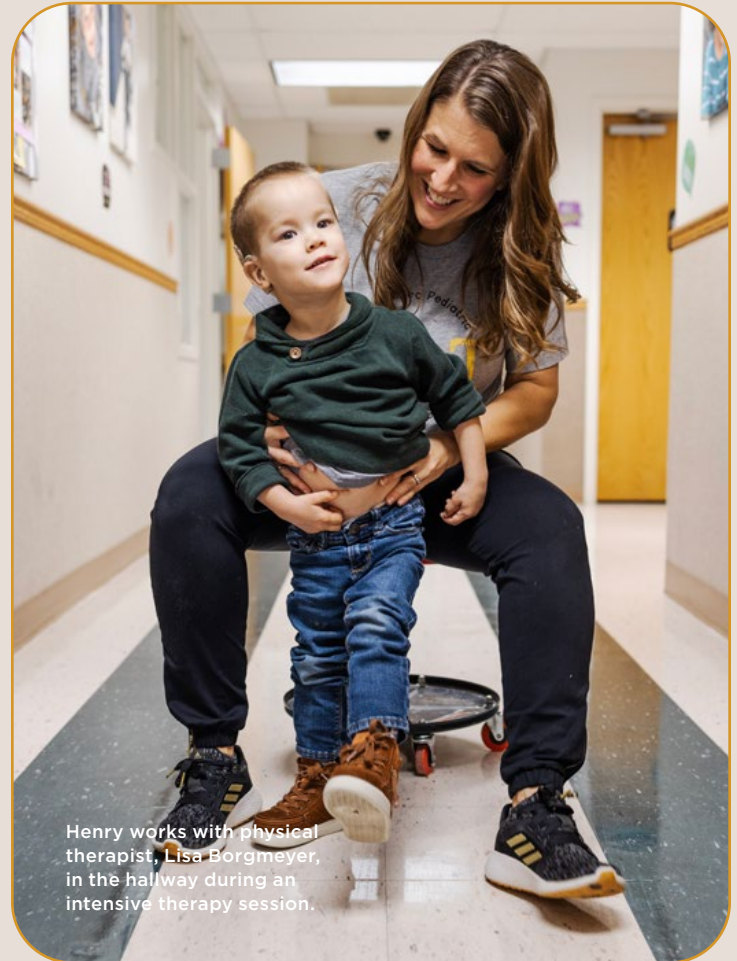

Henry works with physical therapist, Lisa Borgmeyer, in the hallway during an intensive therapy session.

Double the Number of Children Served in Childcare

The Crayon Kids childcare program will expand from three classrooms to six. By doubling the space for childcare, SLC will be able to increase its childcare capacity from 42 children served per day to 84 eliminating the existing waiting list.

Provide State-of-the-Art Therapy Services

Therapy services provided to children in the ECSE program will be in expanded therapy spaces with state-of-the-art therapy equipment designed to help children reach their goals.

The SKIP Clinic will be a stand-alone facility adjacent to the main facility. This dedicated space will provide treatment rooms, intensive therapy rooms, sensorimotor spaces and a large gross motor skills area. The much larger clinic space will eliminate the existing waiting list and allow Special

Learning Center the ability to double the number of children served annually.

Allow Families the Space to Receive Services

The new facility will include a large community room and a family resource center to ensure families have the space needed for outreach and respite activities as well as a resource center with educational materials for families, equipment lending space and a donation closet for families in need.

Open an After School & Summer Program for School Age Children with Special Needs

A new, larger facility will include space for new services such as an after school and expanded summer program for school age children with special needs.



Top: Boden works with his therapist to develop fine motor skills.

Bottom: Amanda McKee, family support specialist, provides services to a family.



WALK through our PLAN



905 Weathered Rock Road,
Jefferson City - renovation
site for new SLC.

The new Special Learning Center campus will include a main facility for early childhood special education classes, childcare program, school age rooms, family support program space and education therapy rooms. An adjacent building will contain the medical-based, pediatric therapy clinic as well as a gross motors skills gymnasium space.

Open the doors to:

- Expanded and additional ECSE and childcare classrooms
- Additional therapy rooms
- Expanded clinic treatment rooms
- Gymnasium and indoor playrooms
- Expanded outdoor track and adaptive playgrounds
- School age after school and summer program room
- Family resource center and community room

Proposed floor plan

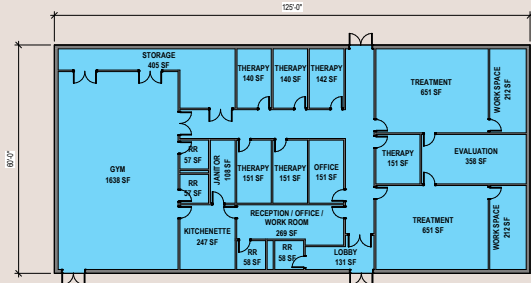
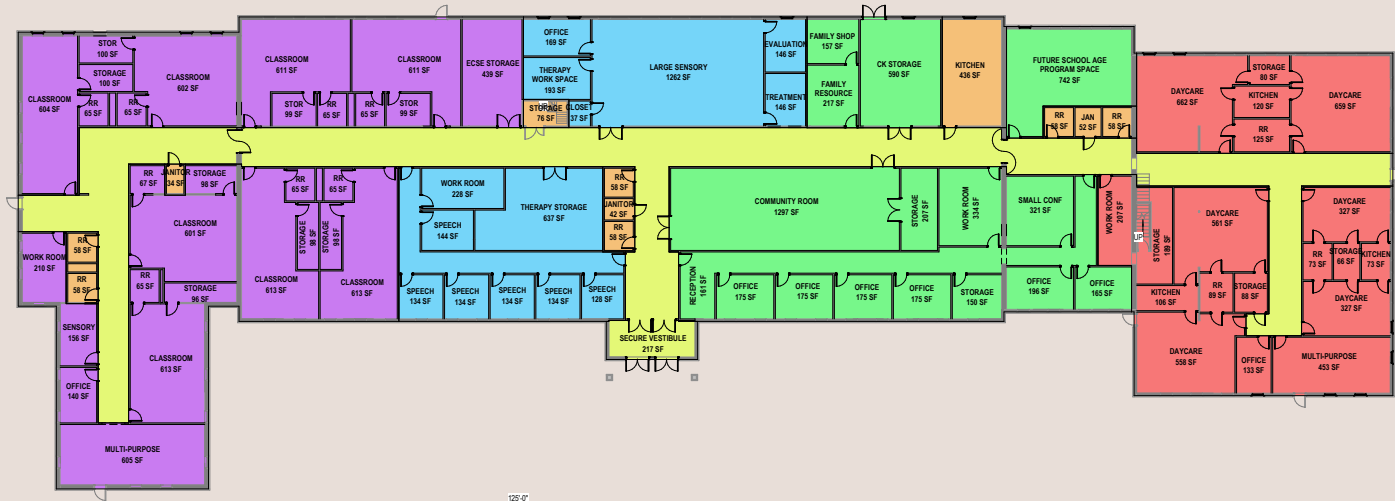

- Main Entrance/Circulation
- Admin/Community & Family Resource Center
- Early Childhood Special Education
- Childcare
- Therapy/Outpatient Clinic
- Support Space



STEP UP to the CHALLENGE

We need your help! Please consider making a pledge to support our Small Steps, Mighty Strides Capital Campaign. Your pledge will ensure Special Learning Center has the space it requires to change the lives of children with special needs.

**Please help us turn
small steps into mighty
strides!**



Thanks to the generosity of the State of Missouri, Cole County, Children's Trust Fund, Special Learning Center Foundation, G.P. Made Foundation and other donors, SLC has already secured \$10,000,000 of the \$13,000,000 needed for this transformative project. The goal of our Small Steps, Mighty Strides Capital Campaign is to raise \$3,000,000 which will close the funding gap needed.

Our children need you to Step Up to the Challenge and make a pledge that will transform small steps into mighty strides!

✚ Itemized list of project costs:

Main Facility Purchase/Construction:	\$8,000,000
Construction of Clinic & Gross Motor Skills Gym:	\$3,000,000
Adaptive Playgrounds:	\$500,000
Therapy & Educational Equipment:	\$500,000
Professional Services:	\$500,000
Contingency & Operations:	\$500,000
<hr/>	
Total Project Cost:	\$13,000,000

For more information on making a pledge or getting involved, visit www.speciallearningcenter.com/campaign.

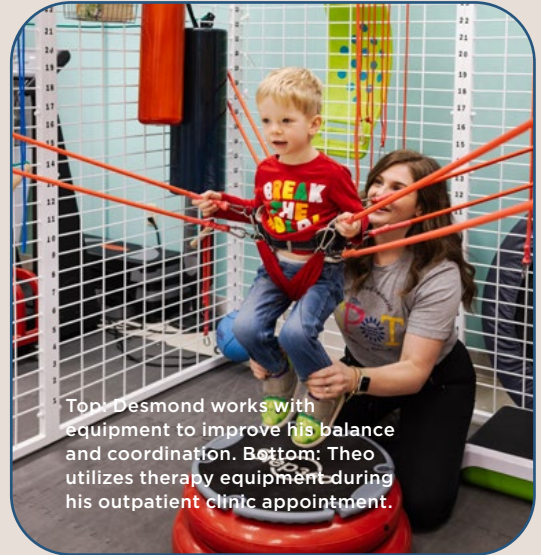
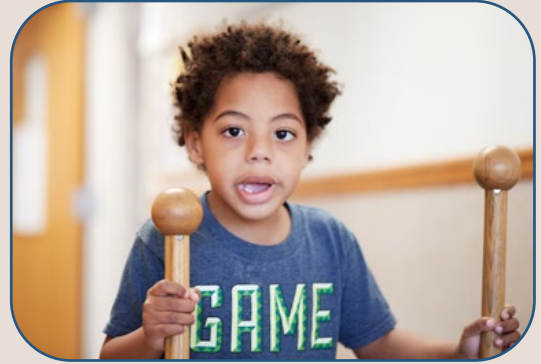

Top: Desmond works with equipment to improve his balance and coordination. Bottom: Theo utilizes therapy equipment during his outpatient clinic appointment.



Special Learning Center

1115 Fairgrounds Road, Jefferson City, MO 65109

573-634-3070

www.speciallearningcenter.com